

# **Jefferson<sup>®</sup>**

## **INDUSTRIAL PRESSURISED 10L Paint Pot System**



Operation Guide



**JEFA052**



**[www.jeffersonontools.com](http://www.jeffersonontools.com)**



## 1. General Safety Guidelines

Please read and ensure that you understand all of the operating instructions, safety precautions and warnings in this Instruction Manual before operating or maintaining this equipment. Most accidents that result from compressor operation and maintenance are caused by the failure to observe basic safety rules or precautions.

An accident can often be avoided by recognizing a potentially hazardous situation before it occurs, and by observing appropriate safety procedures. Never use this equipment in a manner that has not been specifically recommended by manufacturer, unless you first confirm that the planned use will be safe for you and others.

Read all instructions carefully before assembling components and operating this equipment. Incorrect procedure could result in damage to the equipment, severe personal injury and/or property damage. When spraying flammable materials, electric powered products must be placed at least 20 feet from target in a well-ventilated area. Vapours can be ignited by static discharge or electrical sparks and result in severe personal injury.

- 1)** Do not spray paints or other inflammable fluids indoors which have a flash point below 21 degree C, 70 degree F. Keep working environment well ventilated. Turn off all pilot lights and open flames before spraying.
- 2)** Wear a suitable respirator which is approved for the paint product you are using.
- 3)** Do not use halogenated hydrocarbon solvents with this system, which contains aluminium parts and may explode. Cleaning agents, coatings, paints, and adhesives may contain halogenated hydrocarbon solvents. Don't take chances, consult your material supplier to be sure. (e.g. methylene chloride and 1,1,1 - Trichlorethane).
- 4) Caution:** When a flammable liquid is sprayed there may be danger of fire or explosion especially in a closed area.
- 5) Caution:** Arcing parts. Keep the compressor at least 20 feet away from explosive vapours.
- 6) Caution:** Static electricity can be developed by spraying. Ground unit and object to be sprayed. On electric units, unit power cord must be connected to a grounded outlet. Use only three wire extension cords. Static explosion can occur with ungrounded unit.
- 7)** Always follow the safety precautions and warnings printed on paint container and ensure compatibility before use.
- 8)** Do not pull on hoses to move equipment, **DO NOT** kink or bend the hose sharply.
- 9)** Keep children, animals or unqualified individuals away from equipment and work area.
- 10)** Conductive metal containers must be used when flushing flammable fluids through the system. Always flush at low pressure with spray tip removed. A metal part of the spray gun must be held firmly against the grounded metal pail when flushing or relieving pressure from the gun.

### About this equipment

This equipment rugged in construction and designed to operate with the best possible delivery efficiency. Like any fine precision tool, its most efficient operation depends on a solid knowledge of its operation capabilities and maintenance.

With proper material preparation and maintenance, this equipment will produce outstanding performance and uniform finishing results for years to come.

### Compressor & Air Requirements

For optimum results the air compressor should maintain a constant minimum air flow of 7CFM at a minimum of 50psi. Air supply must be clean, dry, and oil free.



#### **DANGER WARNING: Over-pressurisation can result in explosion**

*Any attachments used with this equipment should be checked for compatibility with rated pressure before use.  
Ensure that the equipment connected to the tank or hose outlet has a higher pressure rating than the regulated air pressure in the tank. It is important to avoid over-pressurisation to reduce the risk of explosion, injury or damage.*

Jefferson Tools, Herons Way, Chester Business Park, Chester, CH4 9QR, United Kingdom

**T:** +44 (0) 1244 646 048 **F:** +44 (0) 01244 360 314 **E:** sales@jeffersonstools.com

**www.jeffersonstools.com**



**Do not modify the construction or design of the tank or any other part of this equipment:**

Assemble the tank components in accordance with the instructions contained in this user manual. Do not drill into the tank or weld any attachments to it. Do not alter the design by any means or use the equipment for any other use than it is intended.

**Only use approved attachments parts and components:**

Use only accessories supplied with this equipment and assembled as shown in these instructions. Do not use non-compatible accessories or replacement parts. Contact your nearest authorised Jefferson dealer for advice or telephone **+44 (0) 1244 646 048** for advice.

**Check pressure tank and accessories for damage and correct assembly before use:**

Never use this equipment if it is damaged in anyway. Never try to repair a broken part - contact your nearest authorised Jefferson dealer for advice.

**Ensure that the equipment is cleaned thoroughly after use and maintained regularly:**

Clean and dry the equipment after each use to prevent blockages caused by dirt and debris. Ensure that the ports to the safety valve gauge and outlet are free of hardened paint or other materials which could prevent free movement of air.

**Do not adjust or remove the lid while the tank is under pressure:**

Ensure that the air supply to the equipment is turned off then turn the regulator knob counter clockwise to relieve the air pressure before opening the lid. Check that the tank is not under pressure by pulling the safety valve ring.

**Do not use reactive chemicals:**

Using reactive chemicals can damage the lid gasket and safety valve seal increasing the risk of equipment failure under air pressure. Do not use halogenated hydrocarbon solvents with this system, which contains aluminium parts and may explode. Cleaning agents, coatings, paints, and adhesives may contain halogenated hydrocarbon solvents. Don't take chances, consult your material supplier to be sure. (e.g. methylene chloride and 1,1,1 - Trichlorethane).

**Do not over-tighten the lid clamps:**

Over-tightening the clamps can cause weakening of the lid gasket and reduce the effectiveness of the system and increase the risk of accident. Ensure that the lid gasket is kept clean to avoid leakage. If the gasket is worn or damaged replace it before use, contact your nearest Jefferson Dealer for details.

## 2. Box Contents :

Before assembling and using this equipment please ensure that all the items are included in the box and free from damage.

- 1x** 10L Paint Tank
- 1x** 1.8mm Nozzle Spray Gun
- 1x** 8m Black Paint Hose
- 1x** 8m Red Air Hose
- 1x** Small Brush
- 2x** Assembly and Maintenance Spanners
- 1x** Manual

## 3. Description

This 10L Paint tank is equipped with an air regulator, pressure gauge, safety valve and fluid outlet. The maximum pressure is **80psi**.

**Please note:** This equipment is not designed for use with highly abrasive or corrosive materials or those containing rust which can damage internal parts and increase the risk of product failure and personal injury.

Jefferson Tools, Herons Way, Chester Business Park, Chester, CH4 9QR, United Kingdom

**T:** +44 (0) 1244 646 048    **F:** +44 (0) 01244 360 314    **E:** sales@jeffersontools.com

**www.jeffersontools.com**



## 4. Assembly

1. Connect the regulator assembly to the swivel adaptor on the tank lid. Check the bottom of the regulator for the location of the tank collection.
2. Insert the lift handle into the threaded hole in the centre of the tank lid. Tighten the hex nuts with spanner provided.
3. Connect the air supply hose to an air inlet fitting on the tank regulator (right or left side optional).
4. Attach the atomisation air hose to an air outlet fitting which is directly opposite the air inlet fitting.
5. Connect the material hose to the fluid outlet adaptor located on the tank lid.
6. Check all fittings and connections are secure before use.

## 5. Air Pressure Regulator

The pressure regulator is used to manage the amount of pressure applied to the paint in the tank and determines the pressure of the paint being delivered to the spray gun.

Always start with the pressure in the tank at "zero" and increase the pressure in the tank gradually until the required spray pressure and pattern is obtained for the job at hand.

### Recommended paint tank pressures:

1. **Internal Mix Guns:** Use higher paint tank pressures up to the maximum pressure (but not exceeding 50lbs).
2. **External Mix Guns:** Use lower paint tank pressure.

**Important:** Before turning on the air pressure, screw out the air regulator T-Handle adjusting screw all the way counter-clockwise to shut off the pressure. Turn on the air, then adjust the regulator to the required pressure (approximately 12lbs for external mix guns). Never exceed 50lbs air pressure.

## 6. Operation

1. Before filling the tank, ensure that the paint is thoroughly mixed and strained to remove skins or undissolved particles that might otherwise block the flow of material through the hose and spray gun.

**Note:** The 10L Paint Tank can hold most 1 gallon paint tins (these can be set inside the tank without the user having to pour the paint into the paint tank directly.)

2. Place the lid assembly on the tank and hand tighten the tank lid clamp screws to secure.
3. Shut off the paint tank regulator by turning the T-Handle counter-clockwise. Adjust the compressor regulator to obtain the required air pressure to the spray gun.
4. Adjust the regulator on the paint tank to obtain the desired air pressure for the materials and surface being sprayed. The higher the painting surface is above the level of the paint tank, the more pressure you will need for effective spraying. Normal operating pressure on the paint tank is **25 - 30PSI**. To reduce the pressure, rotate the T-Handle adjusting screw counter clockwise until the desired pressure setting is obtained.

**Important:** Never exceed 80PSI pressure when using this equipment.

## 7. Cleaning & Maintenance

It is very important that the tank, material hose and spray gun are cleaned thoroughly after each use.

**WARNING:** Always ensure that the air supply is turned off and bleed off any excess pressure in the paint tank by pulling the safety valve ring before loosening the thumb screw and clamps to remove the lid.

1. Turn off the main air supply to the tank, remove all pressure from the tank by pulling the safety valve ring until the pressure level bleeds down.
2. Turn the -T-Handle adjusting screw on the regulator counter-clockwise until no spring tension is felt.
3. Loosen the thumb screws, tip clamps and tip the tank lid down to one side. Loosen the spray gun sun air cap retaining ring approximately three turns then turn on the main air supply.
4. Cup a cloth over the air cap on the spray gun and pull the trigger. This will help to force the material back through the hose into the tank.
5. Empty and clean the tank and parts which have come into contact with the spraying materials.
6. Use a suitable non-corrosive solvent to clean the tanks and parts.
7. Replace the lid and secure clamps, reattach the air supply and spray the solvent through the system until it is fully rinsed and sprays clear.

## 8. Troubleshooting

Problem	Cause	Solution
Air escaping from port on regulator cap.	Broken or damaged diaphragm in regulator.	Replace regulator.
Pressure dropping slowly on gauge.	Dirty or worn valve seat in regulator.	Replace regulator.
Fluid or air leak at lid gasket.	Defective lid gasket. Thumb screw bit tight.	Replace lid gasket. Tighten thumb screws.
Gauge not registering air pressure.	Paint not mixed or thinned properly.	Mix or thin paint according to instructions on paint.
Paint in tank tends to settle rapidly.	Defective air gauge.	Replace air gauge.
Safety valve popping off.	Tank pressure too high. Defective safety valve.	Reduce tank pressure to between 20 and 50 PSI. Replace safety valve.

## 7. Parts Diagram

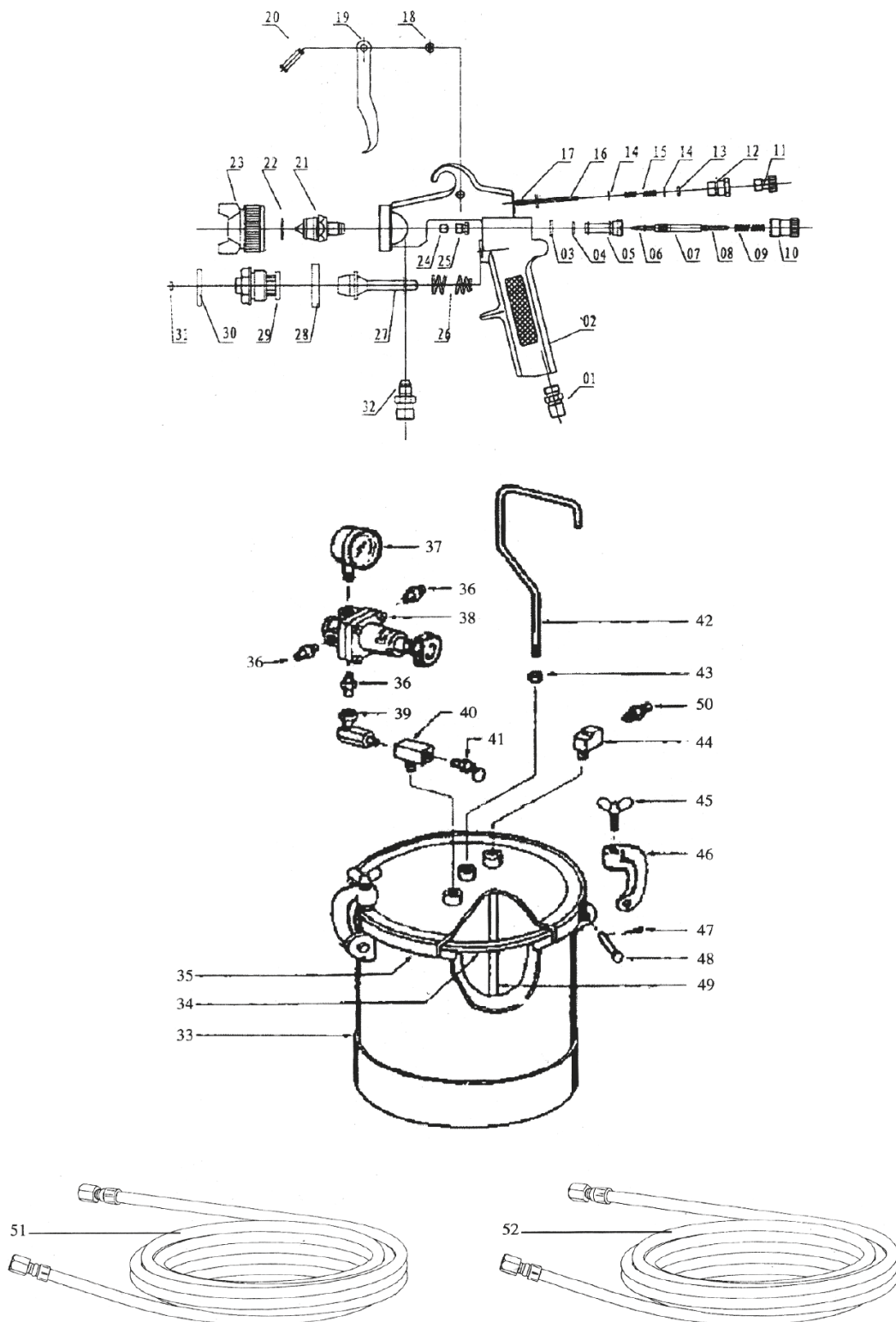

## 8. Parts List

NO	DESCRIPTION	QTY	NO	DESCRIPTION	QTY	NO	DESCRIPTION	QTY
01	Air Inlet Plug	1	19	Trigger	1	37	Gauge	1
02	Gun Body	1	20	Trigger Pin	1	38	Regulator	1
03	Washer	1	21	Fluid Nozzle	1	39	Swivel adapter	1
04	O-Ring	1	22	Washer	1	40	Branch tree	1
05	Needle Socket	1	23	Air Cap	1	41	Safety valve	1
06	Fluid Adj.Needle	1	24	Sealing Washer	1	42	Handle	1
07	Regulating Unit	1	25	Direction Screw	1	43	Hex nut	1
08	Spring Core	1	26	Switch Spring	1	44	Street elbow	1
09	Needle Spring	1	27	Switch Lever	1	45	Thumb screw	4
10	Fluid Adj.Screw	1	28	Sealing Washer	1	46	Yoke screw	4
11	AM Screw Plug A	1	29	Switch Seat	1	47	Cotter pin	4
12	AM Block Lo A	1	30	Sealing Ring	1	48	Hinge pin	4
13	O-Ring	1	31	O- ring	1	49	Fluid tube	1
14	Washer	2	32	Fluid Inlet Plug	1	50	Fluid outlet adapter	1
15	Range Spring	1	33	Tank shell assembly	1	51	Inlet Air Hose(orange)	1
16	Pattern Adj.Screw	1	34	Lid gasket	1	52	Fluid Hose(black)	1
17	AM Plug	1	35	Lid assembly	1			
18	Snap Retainer	1	36	Adapter	3			





## Limited Warranty Statement

Jefferson Professional Tools & Equipment, or hereafter "Jefferson" warrants its customers that its products will be free of defects in workmanship or material.

Jefferson shall, upon suitable notification, correct any defects, by repair or replacement, of any parts or components of this product that are determined by Jefferson to be faulty or defective.

This warranty is void if the equipment has been subjected to improper installation, storage, alteration, abnormal operations, improper care, unauthorised service or repair.

### Warranty Period

Jefferson will assume both the parts and labour expense of correcting defects during the stated warranty periods below.

All warranty periods start from the date of purchase from an authorised Jefferson dealer. If proof of purchase is unavailable from the end user, then the date of purchase will be deemed to be 3 months after the initial sale to the distributor.

#### 1 Year

- Jefferson 10L Paint Pot (excluding consumable parts and materials e.g. hoses, spray guns etc.)

#### 90 Days

- All replacement parts purchased outside of the warranty period

**Important:** All parts used in the repair or replacement of warranty covered equipment will be subject to a minimum of 90 days cover or the remaining duration of the warranty period from the original date of purchase.

### Warranty Registration / Activation

You can register and activate your warranty by visiting the Jefferson Tools website using the following address:

**[www.jeffersontools.com/warranty](http://www.jeffersontools.com/warranty)** and completing the online form. Online warranty registration is recommended as it eliminates the need to provide proof of purchase should a warranty claim be necessary.

### Warranty Repair

Should Jefferson confirm the existence of any defect covered by this warranty the defect will be corrected by repair or replacement at an authorized Jefferson dealer or repair centre.

### Packaging & Freight Costs

The customer is responsible for the packaging of the equipment and making it ready for collection **together with a copy of the original proof of purchase**. Jefferson will arrange collection and transportation of any equipment returned under warranty.

Upon inspection of the equipment, if no defect can be found or the equipment is not covered under the terms of the Jefferson warranty, the customer will be liable for any labour and return transportation costs incurred.

These costs will be agreed with the customer before the machine is returned.

### Warranty Limitations

Jefferson will not accept responsibility or liability for repairs made by unauthorised technicians or engineers. Jefferson's liability under this warranty will not exceed the cost of correcting the defect of the Jefferson products.

Jefferson will not be liable for incidental or consequential damages (such as loss of business or hire of substitute equipment etc.) caused by the defect or the time involved to correct the defect. This written warranty is the only express warranty provided by Jefferson with respect to its products.

Any warranties of merchantability are limited to the duration of this limited warranty for the equipment involved.

Jefferson is not responsible for cable wear due to flexing and abrasion. The end user is responsible for routine inspection of cables for possible wear and to correct any issues prior to cable failure.

Jefferson Tools, Herons Way, Chester Business Park, Chester, CH4 9QR, United Kingdom

**T:** +44 (0) 1244 646 048 **F:** +44 (0) 01244 360 314 **E:** [sales@jeffersontools.com](mailto:sales@jeffersontools.com)

**[www.jeffersontools.com](http://www.jeffersontools.com)**





## Claiming Warranty Coverage

The end user must contact Jefferson Professional Tools & Equipment (Tel: +44 (0) 1244 646 048) or their nearest authorised Jefferson dealer where final determination of the warranty coverage can be ascertained.

### Step 1 - Reporting the Defect

#### Online Method:

- Visit our website [www.jeffersontools.com/warranty](http://www.jeffersontools.com/warranty) and complete the Warranty Returns form. You can complete the form online and submit it to us directly or download the form to print out and return by post.

#### Telephone Method:

Contact your Jefferson dealer or sales representative with the following information:

- Model number
- Serial number (usually located on the specification plate)
- Date of purchase

A Warranty Returns form will be sent to you for completion and return by post or fax, together with details of your nearest authorised Jefferson repair centre. On receipt of this form Jefferson will arrange to collect the equipment from you at the earliest convenience.

### Step 2 - Returning the Equipment

It is the customer's responsibility to ensure that the equipment is appropriately and securely packaged for collection. Please ensure that you include a copy of your proof of purchase. Please note that Jefferson cannot assume any responsibility for any damage incurred to equipment during transit. Any claims against a third party courier will be dealt with under the terms & conditions of their road haulage association directives.

### Step 3 - Assessment and Repair

On receipt, the equipment will be assessed by an authorised Jefferson engineer and it will be determined if the equipment is defective and in need of repair and any repairs needed are covered by the warranty policy. In order to qualify for warranty cover all equipment presented must have been used, serviced and maintained as instructed in the user manual.

Where repair is not covered by the warranty a quotation for repair, labour costs and return delivery will be sent to the customer (normally within 7 working days).

**Note:** If the repair quotation is not accepted Jefferson Professional Tools & Equipment will invoice 1 hour labour time at £30 per hour plus return carriage costs (plus VAT).

*In cases where no fault can be found with the equipment, or, if incorrect operation of the equipment is identified as the cause of the problem, a minimum of 1 hour labour at £30 per hour plus carriage costs will be required before the equipment will be despatched back to the customer.*

*Any equipment repaired or replaced under warranty will normally be ready for shipment back to the customer within 7 working days upon receipt of the equipment at an authorised Jefferson Repair centre (subject to part availability). Where parts are not immediately available Jefferson will contact you with a revised date for completion of the repair.*

## General Warranty Enquiries

For any further information relating to Jefferson warranty cover please call **+44 (0) 1244 646 048** or send your enquiry via email to [warranty@jeffersontools.com](mailto:warranty@jeffersontools.com).

Jefferson Tools, Herons Way, Chester Business Park, Chester, CH4 9QR, United Kingdom

**T:** +44 (0) 1244 646 048    **F:** +44 (0) 01244 360 314    **E:** [sales@jeffersontools.com](mailto:sales@jeffersontools.com)

**[www.jeffersontools.com](http://www.jeffersontools.com)**



## EC Declaration Of Conformity

We, Jefferson Professional Tools & Equipment, as the authorised European Community representative of the manufacturer, declare that the following equipment conforms to the requirements of the following Directives:

97/23/EC (as amended)

**Pressure Equipment Directive**

**Equipment Category:**

Coating Vessels

**Notified Body:**

TUV SUD Industrie Service  
IS-DBB-MUC  
Westendr. 199  
80686

**Signed by:**

Stephen McIntyre

**Position in the company:**

Operations Director

**Date:**

03 September 2015

**This technical document is held by:**

Jimmy Hemphill

*Technical file holder's address as shown below.*

**Name and address of manufacturer or authorised representative:**

Jefferson Tools, Herons Way, Chester Business Park, Chester, CH4 9QR, United Kingdom

**T:** +44 (0) 1244 646 048 **F:** +44 (0) 01244 360 314 **E:** sales@jeffersonstools.com

**www.jeffersonstools.com**



## **IMPORTANT! SAFETY FIRST!**

Before attempting to use this product please read all the safety precautions and operating instructions outlined in this manual to reduce the risk of fire, electric shock or personal injury.